



VIGNESH PEB SOLUTIONS PVT. LTD.

Transforming Spaces with PEB Expertise



connect@vigneshpeb.com
www.vigneshroofingsystems.com

+91 98480 60444
www.vigneshpeb.com

INTRODUCTION

Vignesh Peb Solutions, established in 2006 under the visionary leadership of Mr. Vignesh, has consistently set benchmarks in the construction industry, our firm initially focused on Local contracts and quickly gained a reputation for precise and dependable project delivery.

In 2013, we embraced a new era by expanding into Pre-Engineered Building Systems & Prefab Structures, launching Vignesh Peb Solutions Project (P) Ltd. This significant transformation positioned us as a leading provider of Pre-Engineered Steel Construction solutions in India.

Our commitment to excellence was further solidified in 2024 when we proudly registered as a Private Limited Company. This milestone marks our unwavering dedication to growth and innovation.

From conceptualization to completion, Vignesh Roofing Systems offers comprehensive services tailored to the diverse needs of our clients. Our expertise spans Industrial & Warehousing Solutions, making us your trusted one-stop solution provider.



WHAT WE OFFER

Customized PEB Solutions: Our expert team collaborates closely with clients to design and fabricate buildings tailored to their specific requirements, ensuring optimal functionality and aesthetics.

High-Quality Materials: We source only the finest materials to guarantee the longevity and resilience of our structures, adhering to international standards and best practices.

Comprehensive Services: From initial consultation and design to fabrication, delivery, and installation, we provide end-to-end services to ensure a seamless and hassle-free experience for our clients.

Advanced Technology: Utilizing state-of-the-art technology and equipment, we ensure precision and excellence in every aspect of our projects, from design to execution.

Sustainability: Committed to environmental stewardship, our PEB solutions incorporate sustainable practices and materials, contributing to greener and more energy efficient buildings.

WHY CHOOSE US?

Expertise : With 18 years of experience and a team of highly skilled professionals, we bring unparalleled expertise to every project.

Innovation : Our innovative approach and continuous improvement culture drive us to deliver cutting-edge solutions that meet the highest industry standards.

Customer Satisfaction : We prioritize our clients needs and strive to exceed their expectations, ensuring complete satisfaction with our products and services.

Reliability : Dependability and trustworthiness are the cornerstones of our business, making us a preferred partner for clients worldwide.

KEY FEATURES OF TURNKEY SOLUTIONS





OUR ENGINEERING TEAMS

- Structural Engineers
- Civil Engineers
- Mechanical Engineers
- Electrical Engineers
- Architectural Engineers
- Fabrication and Detailing Team
- Project Managers and Coordinators
- Safety Engineers
- Environmental Engineers

ENGINEERING TEAM

Our engineering team plays a pivotal role in Pre-Engineered Building (PEB) constructions. Our engineers are involved from the initial design phase, crafting tailored structural solutions that meet specific project requirements. They ensure all designs comply with stringent safety and quality standards. By selecting optimal materials, they balance cost and durability, contributing to sustainable construction practices.

During fabrication and assembly, our engineers provide hands-on supervision, ensuring precision and addressing any technical challenges that arise. Their expertise in structural analysis, project management, and innovative engineering solutions ensures our PEB constructions are efficient, reliable, and delivered on time, exceeding client expectations.



PLANT



- CNC Plasma
- CNC Hydraulic Press Brake
- Sheet Rolling
- Automatic H-Beam
- Standing Seam
- Curved Profiling & Flashing
- Z & C Purlin
- Continuous Seam Down Pipe
- Shearing Machine
- Hydraulic Iron Worker
- MIG & ARC Welding
- Screw & Piston Compressor



OUR FABRICATION PLANT

At **Vignesh Peb Solutions**, our state-of-the-art fabrication plant is central to our operations. Equipped with advanced machinery and manned by a skilled workforce, we ensure precision and quality in every component. Rigorous quality control measures and efficient work flows enable us to meet tight deadlines without compromising on standards.



ERECTION SERVICES

At Vignesh Peb Solutions, our erection services are designed to ensure the efficient and precise assembly of Pre-Engineered Buildings (PEBs). Our experienced team handles every aspect of the erection process with meticulous attention to detail, ensuring structural integrity and safety. Utilizing advanced equipment and adhering to strict safety protocols, we complete projects on schedule and within budget.

Our commitment to quality and efficiency guarantees that each structure is assembled to the highest standards, providing durability and reliability for long-term performance. Trust us to deliver seamless and professional erection services that support the successful completion of your construction projects





ENVIRONMENT HEALTH & SAFETY

RISK
ASSESSMENT

SAFETY
PROCEDURES

TRAINING &
EDUCATION

PERSONAL
PROTECTIVE
EQUIPMENT
(PPE)

EMERGENCY
PREPAREDNESS

HEAT STRESS
PREVENTION

ENVIRONMENTAL
PROTECTION

HEALTH &
WELLNESS

COMPLIANCE
MONITORING

COMMUNICATION
&
REPORTING

CONTINUOUS
IMPROVEMENT

EQUIPMENT
MAINTENANCE

EHS

DOME STRUCTURE

Without columns or any support system rising from the floor below, a dome's hemispherical roof is supported by a few key forces :

The support force that the dome's structure receives from contact with the base and the earth the building is resting on is known as the normal force of nature. This force exerts upward pressure on the earth. Gravity is a force of nature that pulls the dome downward and is created when everything on Earth is drawn toward its center.

Another way to think of gravity is as the weight of the materials that went into building the dome. Compression is the force that pushes in from all sides onto every part of a dome. Imagine a brick dome where the pressure of the other bricks is applied to each brick.



CIVIL WORKS FOR PEB

At **Vignesh Peb Solutions**, we offer comprehensive civil works services to complement our Pre-Engineered Building (PEB) solutions. Our skilled team manages all aspects of civil engineering, including site preparation, foundation work, and structural integration, ensuring a solid base for your PEB. We employ advanced techniques and adhere to the highest standards of quality and safety, providing seamless integration between civil infrastructure and PEB systems. Our commitment to precision and efficiency ensures that your project progresses smoothly from groundwork to final assembly, delivering reliable and durable structures that meet your specific needs.





PEB

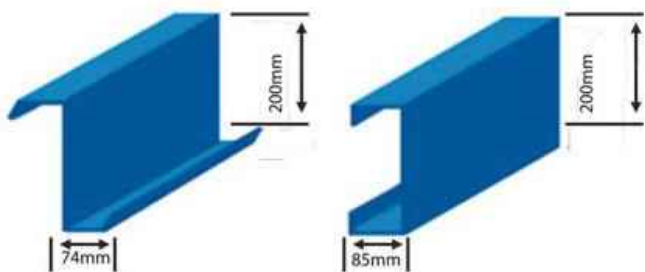
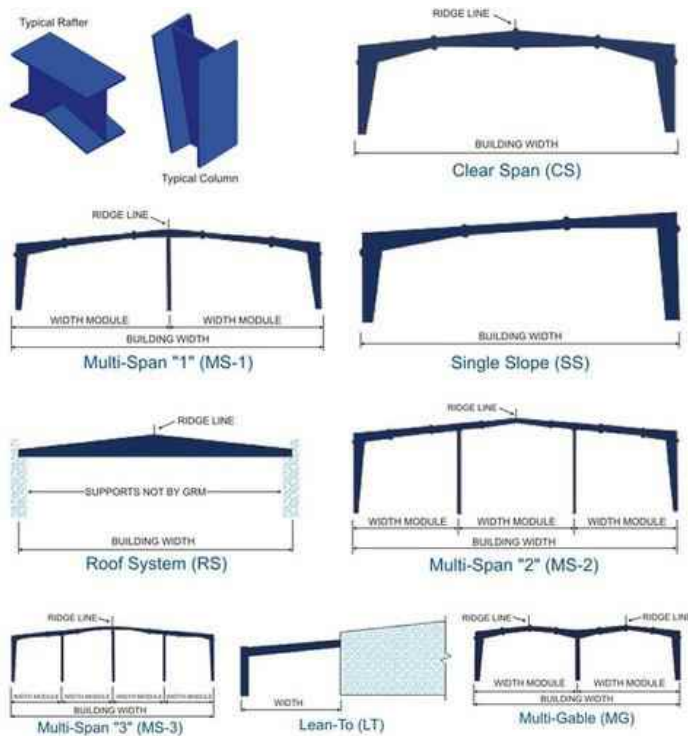
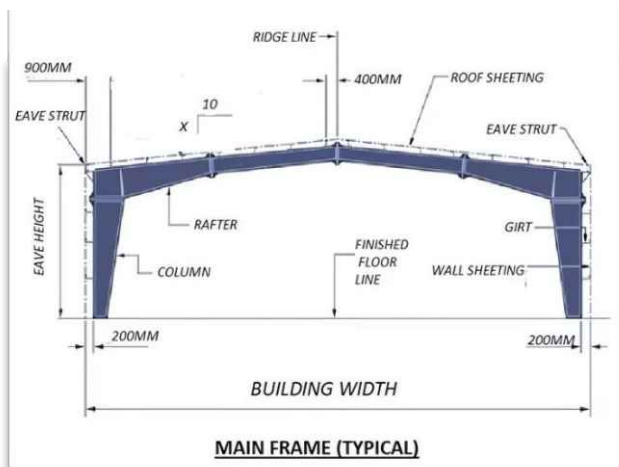
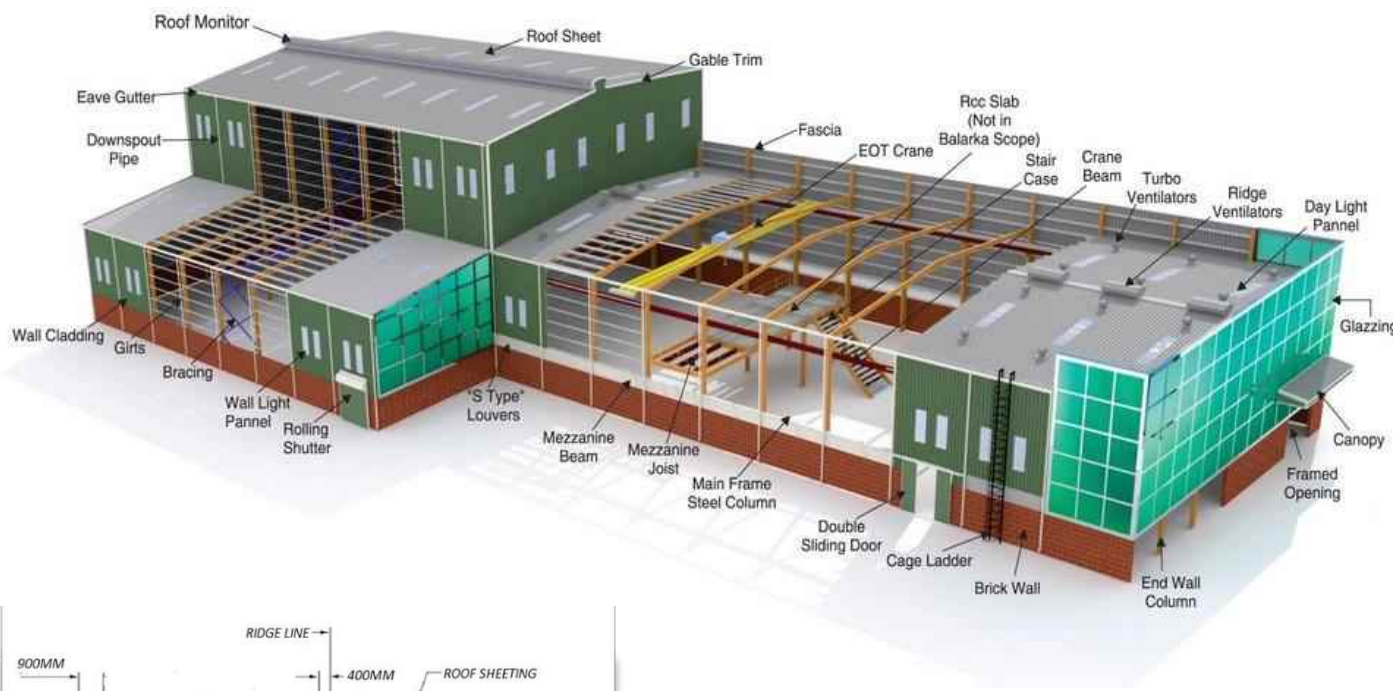

Typical "Z" Section

Typical "C" Section

ACCESSORIES

RIDGE VENT

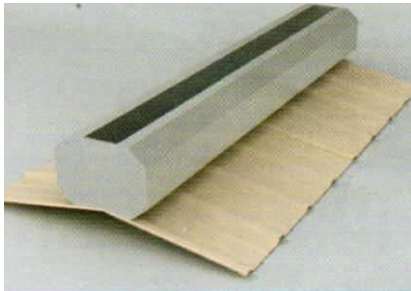

TURBO VENTILATOR



TRIMS & FLASHINGS

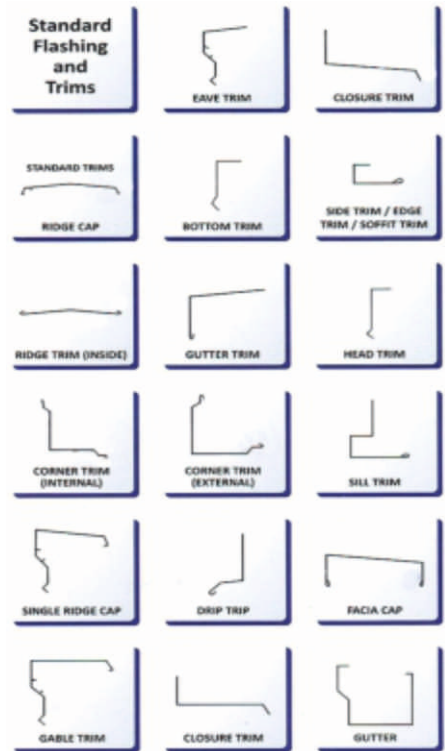

SKY LIGHT



WALL LIGHT



S TYPE LOUVERS



WALL OPENING



FASTENERS



CANOPY



FASCIA



INSULATION



DISCOVER THE EXCELLENCE OF STANDING SEAM ROOFING

Unmatched Durability and Style Standing seam roofing is renowned for its superior durability and sleek, modern appearance. Its unique design features raised seams that interlock to provide a watertight seal, ensuring your roof remains resilient against the harshest weather conditions.

KEY BENEFITS

- 1. Long-Lasting Performance:** Crafted from high-quality metal, standing seam roofs are built to last. They can endure extreme temperatures, high winds, and heavy snowfall, offering unparalleled protection for your home or business.
- 2. Low Maintenance:** Unlike traditional roofing materials, standing seam roofs require minimal upkeep. Their interlocking seams prevent leaks and reduce the risk of damage, saving you time and money on maintenance.
- 3. Energy Efficiency:** Reflective metal surfaces help to deflect the sun's rays, keeping your building cooler in the summer. This energy-efficient feature can lead to significant savings on your cooling costs.
- 4. Aesthetic Appeal:** Available in a variety of colors and finishes, standing seam roofs can be customized to match your style. Their clean lines and modern look add a touch of elegance to any structure.
- 5. Environmentally Friendly:** Made from recyclable materials, standing seam roofs are an eco-friendly choice. They contribute to a sustainable building practice, reducing your environmental footprint.

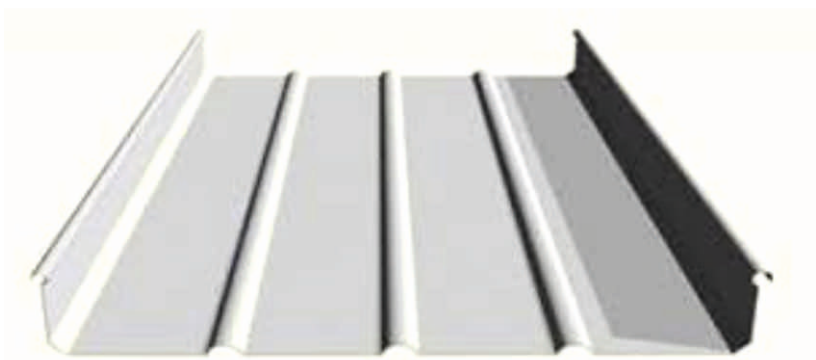



PREFABRICATED HIGH RISE BUILDINGS

Prefabricated high-rise buildings are structures where most of the components, such as walls, floors, and even entire rooms, are manufactured off-site in a factory and then transported to the construction site for assembly. This method is often called modular construction. Key Features of Prefabricated High-Rise Buildings:

1. **Speed of Construction:** Since many elements are pre-made, construction time on-site is significantly reduced.
2. **Cost Efficiency:** Prefabrication can lower costs due to mass production, reduced labor time on-site, and less waste.
3. **Quality Control:** Factory production allows for better quality control of building components compared to traditional on-site construction.
4. **Environmental Benefits:** Prefabrication often results in less material waste and can reduce the overall environmental footprint of a project.
5. **Design Flexibility:** Modern techniques allow for a wide range of architectural designs, making it possible to create visually appealing and structurally sound high-rise buildings.



OUR CLIENTS



VASUGAN MEDICAL
SPECIALITIES PVT. LTD.





OUR PRESENCE

CALL : +91 98480 60444 | 88860 60444
E-MAIL : connect@vigneshpeb.com
WEB : www.vigneshpeb.com

PLANT ADDRESS

11-19, Pinagadi Simhachalam Road, Rampuram,
Andhra Pradesh - 531173.

OFFICE - 1

50-50-15/3, Seethammadhara,
Near Prime Shoe Mart,
Visakhapatnam - 533013

OFFICE - 2

Flat No. 201, NSH Emerald, Sriven Enclave,
Gajularamaram, Hyderabad - 500 055
+91 8367060444